

SHEET 5.05

REVISIONS			
DATE	L. S. NAME	LIC. NO.	DESCRIPTION
10/25/19	R. CIGOL	24GS04026100	EXEMPT STATUS B. 5105 L. 16
10/20/20	R. CIGOL	24GS04026100	SEWER EASEMENT B. 5105 L. 1
12/31/21	R. CIGOL	24GS04026100	CONSOLIDATE B. 5105 L. 16 INTO B. 5105 L. 15
	R. CIGOL	24GS04026100	EXEMPT STATUS B. 5093 L. 8

THIS MAP HAS BEEN DRAWN USING COMPUTER AIDED DRAFTING/DESIGN (CAD/D) UNDER THE SUPERVISION OF ROBERT L. CIGOL, N.J.L.S. No. 24GS04026100.

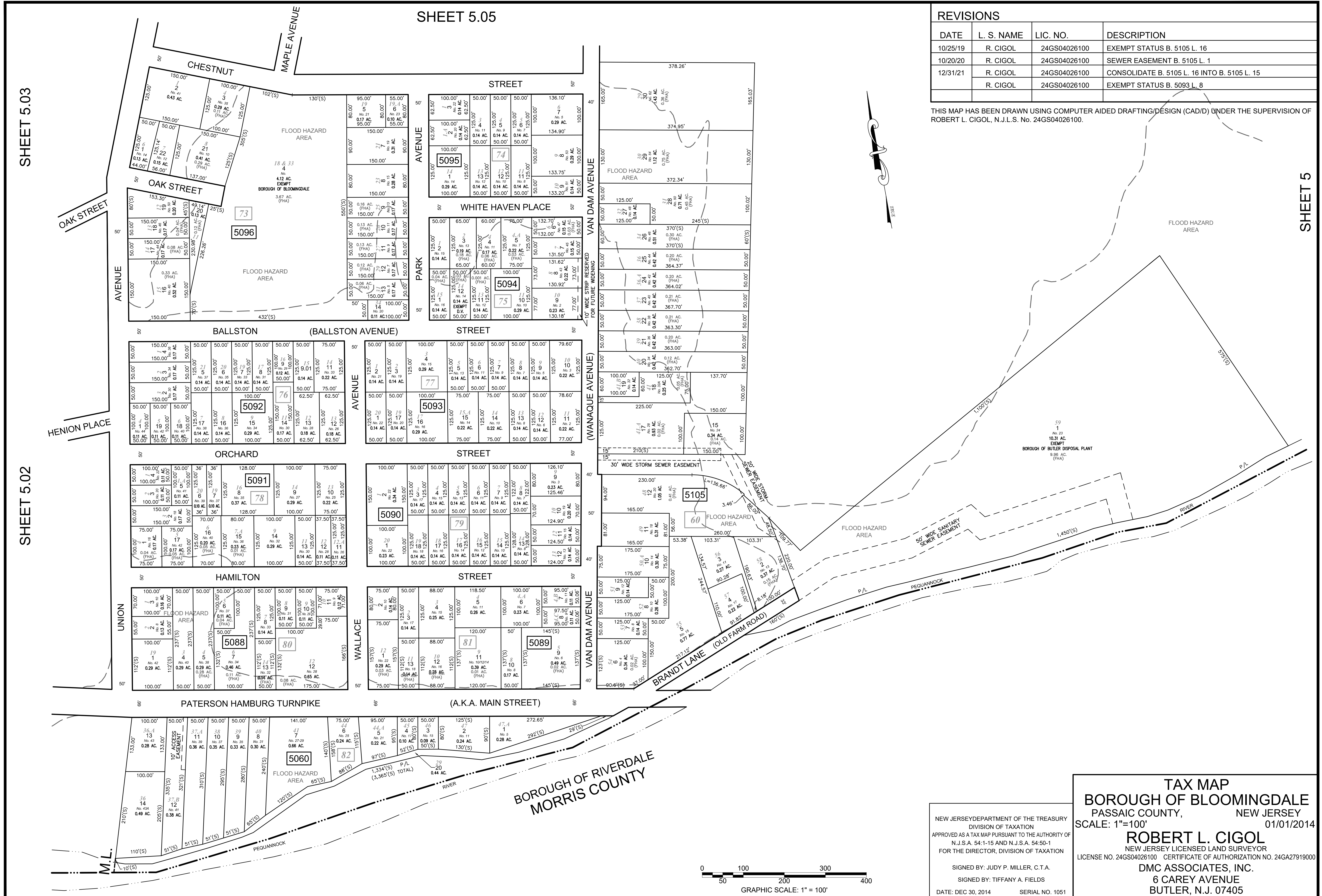

TAX MAP
BOROUGH OF BLOOMINGDALE
 PASSAIC COUNTY, NEW JERSEY
 SCALE: 1"=100' 01/01/2014
ROBERT L. CIGOL
 NEW JERSEY LICENSED LAND SURVEYOR
 LICENSE NO. 24GS04026100 CERTIFICATE OF AUTHORIZATION NO. 24GA27919000
DMC ASSOCIATES, INC.
 6 CAREY AVENUE
 BUTLER, N.J. 07405
 TO SHOW CONDITIONS AS OF 12/31/2021

NEW JERSEY DEPARTMENT OF THE TREASURY
 DIVISION OF TAXATION
 APPROVED AS A TAX MAP PURSUANT TO THE AUTHORITY OF
 N.J.S.A. 54:1-15 AND N.J.S.A. 54:50-1
 FOR THE DIRECTOR, DIVISION OF TAXATION
 SIGNED BY: JUDY P. MILLER, C.T.A.
 SIGNED BY: TIFFANY A. FIELDS
 DATE: DEC 30, 2014 SERIAL NO. 1051

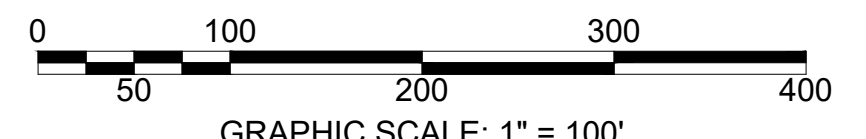

SHEET 5.03

SHEET 5.02

SHEET 5