

SHEET 3.05

REVISIONS			
DATE	L. S. NAME	LIC. NO.	DESCRIPTION
11/25/15	R. CIGOL	24GS04026100	EXEMPT STATUS BL. 3030 L. 15, REMOVE BL. 3031 L. 9.01, REVISED BL. 3030 L. 32 & 33 (SUBDIVISION)

THIS MAP HAS BEEN DRAWN USING COMPUTER AIDED DRAFTING/DESIGN (CAD/D) UNDER THE SUPERVISION OF ROBERT L. CIGOL, N.J.L.S. No. 24GS04026100.

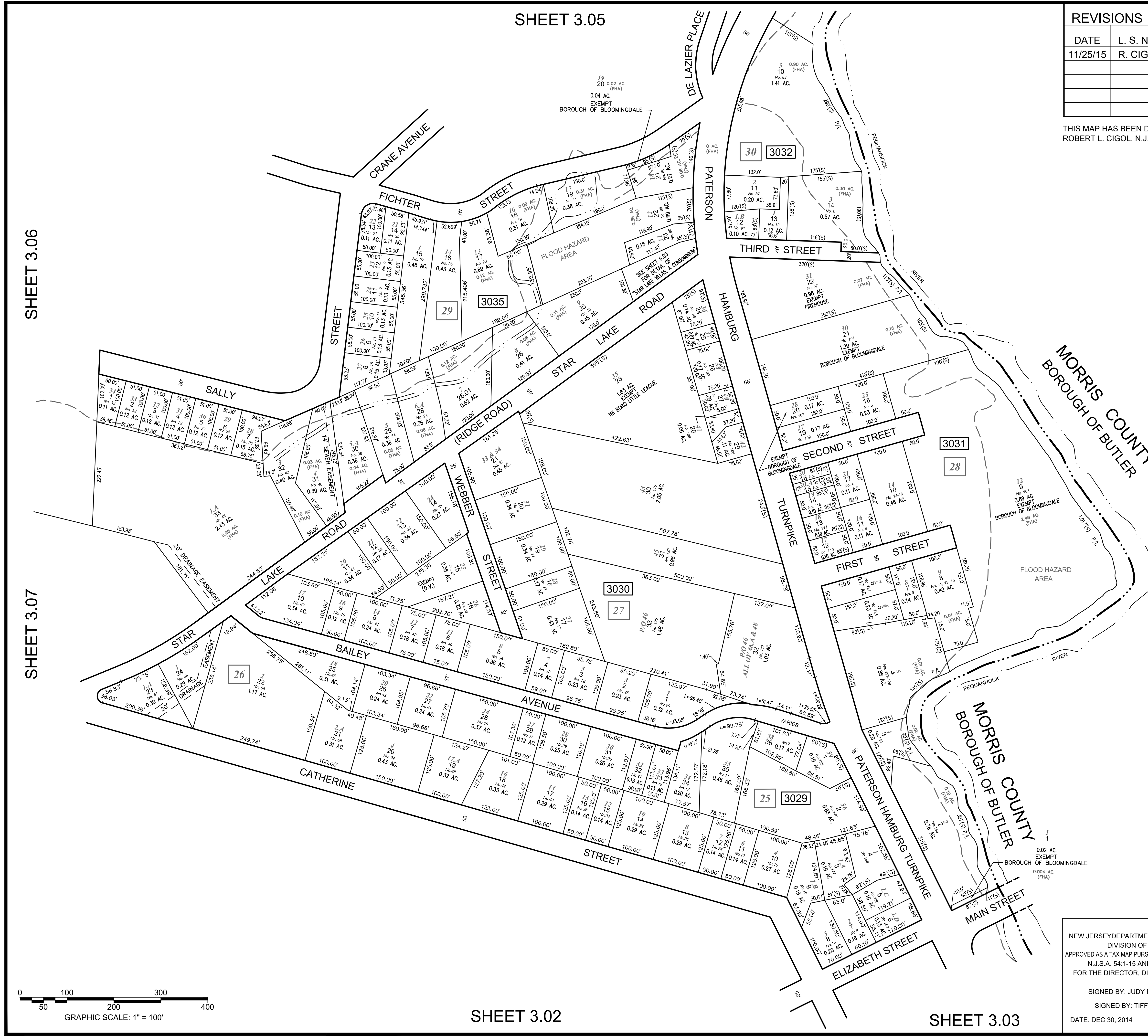

SHEET 3.06

SHEET 3.07

SHEET 3.02

SHEET 3.03

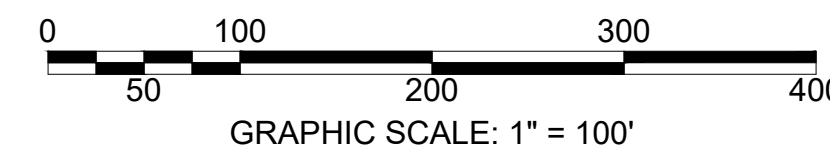

NEW JERSEY DEPARTMENT OF THE TREASURY
 DIVISION OF TAXATION
 APPROVED AS A TAX MAP PURSUANT TO THE AUTHORITY OF
 N.J.S.A. 54:1-15 AND N.J.S.A. 54:50-1
 FOR THE DIRECTOR, DIVISION OF TAXATION

SIGNED BY: JUDY P. MILLER, C.T.A.
 SIGNED BY: TIFFANY A. FIELDS
 DATE: DEC 30, 2014 SERIAL NO. 1051

TAX MAP
BOROUGH OF BLOOMINGDALE
 PASSAIC COUNTY, NEW JERSEY
 SCALE: 1"=100' 01/01/2014

ROBERT L. CIGOL
 NEW JERSEY LICENSED LAND SURVEYOR
 LICENSE NO. 24GS04026100 CERTIFICATE OF AUTHORIZATION NO. 24GA27919000

DMC ASSOCIATES, INC.
 6 CAREY AVENUE
 BUTLER, N.J. 07405
 TO SHOW CONDITIONS AS OF 11/25/2015