

REVISIONS			
DATE	L. S. NAME	LIC. NO.	SHEET. NO.
11/25/2015	R. CIGOL	24GS04026100	2.02, 3.01, 3.04, 3.07, 3.08, 4.01, 5.03, & 5.06
11/14/2016	R. CIGOL	24GS04026100	3.01, 3.07, 4, 4.01, 4.06, 5.02, 5.03, 5.05 & 5.06
11/15/2017	R. CIGOL	24GS04026100	KEY, 3.05, 4.03, 5, 5.02
11/01/2018	R. CIGOL	24GS04026100	KEY, 3.01, 3.07, 3.08, 5.09
10/25/2019	R. CIGOL	24GS04026100	2.01, 3.05, 3.06, 3.08, 4.03, 5, 5.01, 5.02, 5.04, 5.05
10/20/2020	R. CIGOL	24GS04026100	3.01, 3.02, 3.03, 5.04
12/31/2021	R. CIGOL	24GS04026100	KEY, 2.03, 3, 3.07, 3.08, 4, 4.04, 5.02, & 5.04

THIS MAP HAS BEEN DRAWN USING COMPUTER AIDED DRAFTING/DESIGN (CAD/D) UNDER THE SUPERVISION OF ROBERT L. CIGOL, N.J.L.S. No. 24GS04026100.

THIS MAP SUPERSEDES THE TAX MAP APPROVED DECEMBER 1, 2010.

LEGEND	
	DETAIL SHEET NUMBER
	PRIOR BLOCK NUMBER
	BLOCK NUMBER
	SHEET LIMIT LINE
	BLOCK LIMIT LINE
	COUNTY BOUNDARY LINE
	MUNICIPAL BOUNDARY LINE
	STREAM & WATER LINE
	EASEMENT OR LEASED LINE
	PRIOR LOT NUMBER
	LOT NUMBER
	HOUSE NUMBER
	FLOOD HAZARD AREA

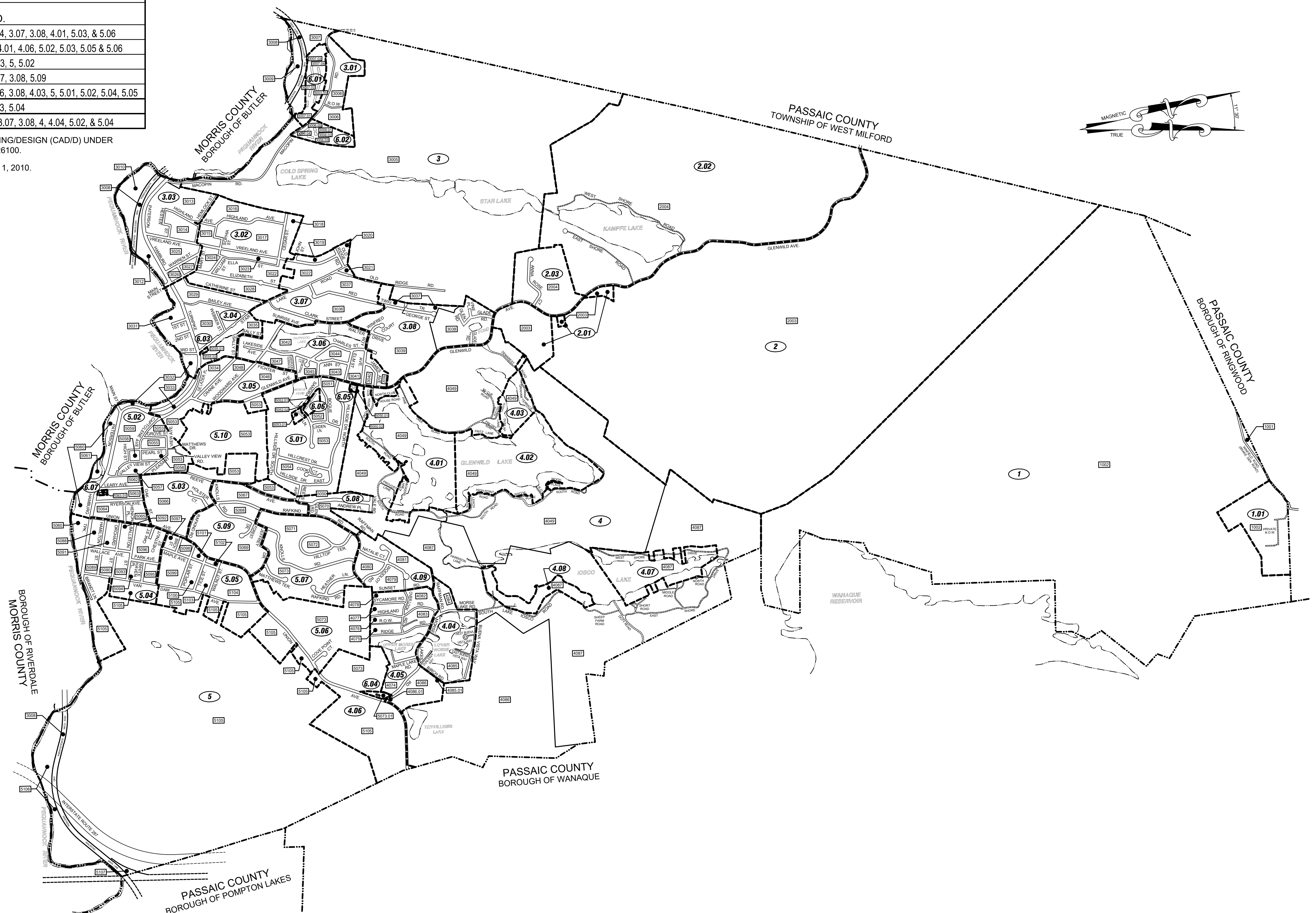

THE AREAS, BOUNDARIES AND DIMENSIONS SHOWN ON THIS TAX MAP, ARE DERIVED FROM GROUND SURVEYS, AERIAL SURVEYS, AND RECORDED PLANS, MAPS, DEEDS, WILLS, AND ARE TO BE USED FOR ASSESSMENT PURPOSES ONLY.

I HEREBY CERTIFY THAT THIS MAP HAS BEEN REVISED UNDER MY IMMEDIATE SUPERVISION AND COMPLIES WITH THE LAWS OF THE STATE OF NEW JERSEY.

ROBERT L. CIGOL, N.J.L.S. NO. 24GS04026100  
 CERTIFICATE OF AUTHORIZATION NO. 24GA27919000

NEW JERSEY DEPARTMENT OF THE TREASURY  
 DIVISION OF TAXATION  
 PROPERTY ADMINISTRATION  
 APPROVED AS A TAX MAP PURSUANT TO THE AUTHORITY OF  
 N.J.S.A. 54:1-15 & 54:50-1  
 FOR THE DIRECTOR, DIVISION OF TAXATION  
 SIGNED BY: JUDY P. MILLER, C.T.A.  
 SIGNED BY: TIFFANY A. FIELDS, C.T.A.  
 DATE: DEC 30, 2014 SERIAL NO. 1051

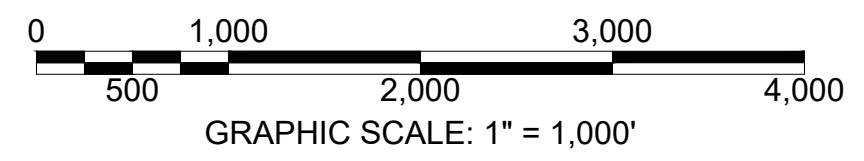

**TAX MAP**  
**BOROUGH OF BLOOMINGDALE**  
 PASSAIC COUNTY, NEW JERSEY  
 SCALE: 1"=1,000' 01/01/2014  
**ROBERT L. CIGOL**  
 NEW JERSEY LICENSED LAND SURVEYOR  
 LICENSE NO. 24GS04026100 CERTIFICATE OF AUTHORIZATION NO. 24GA27919000  
**DMC ASSOCIATES, INC.**  
 211 MAIN STREET BUTLER, N.J. 07405  
 TO SHOW CONDITIONS AS OF 12/31/2021