

REVISIONS			
DATE	L. S. NAME	LIC. NO.	DESCRIPTION

THIS MAP HAS BEEN DRAWN USING COMPUTER AIDED DRAFTING/DESIGN (CAD/D) UNDER THE SUPERVISION OF ROBERT L. CIGOL, N.J.L.S. No. 24GS04026100.

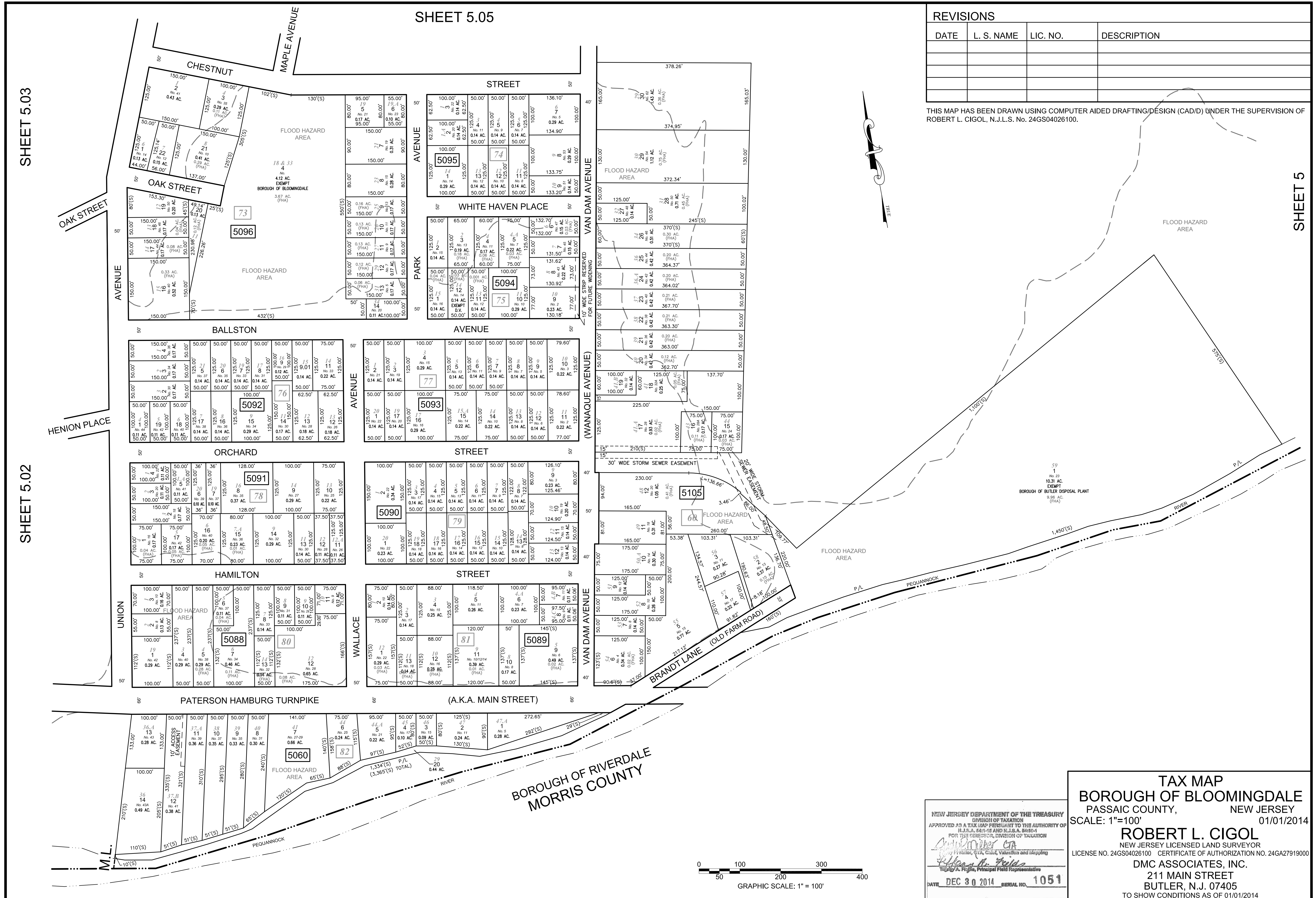

NEW JERSEY DEPARTMENT OF THE TREASURY
 DIVISION OF TAXATION
 APPROVED AS A TAX MAP PURSUANT TO THE AUTHORITY OF
 N.J.S.A. 64:1-16 AND N.J.S.A. 64:5-4
 FOR THE DIRECTOR, DIVISION OF TAXATION
Robert L. Cigol
 Robert L. Cigol, P.E., C.L.S., Valuation and Mapping
 License No. 24GS04026100
 DATE DEC 30 2014 SERIAL NO. 1051

TAX MAP
BOROUGH OF BLOOMINGDALE
 PASSAIC COUNTY, NEW JERSEY
 SCALE: 1"=100' 01/01/2014
ROBERT L. CIGOL
 NEW JERSEY LICENSED LAND SURVEYOR
 LICENSE NO. 24GS04026100 CERTIFICATE OF AUTHORIZATION NO. 24GA27919000
DMC ASSOCIATES, INC.
 211 MAIN STREET
 BUTLER, N.J. 07405
 TO SHOW CONDITIONS AS OF 01/01/2014

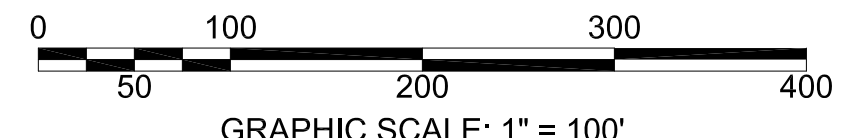

SHEET 5.03

SHEET 5.02

SHEET 5.05

SHEET 5