

SHEET 5.10

SHEET 5.03

SHEET 3.05

SHEET 5.04

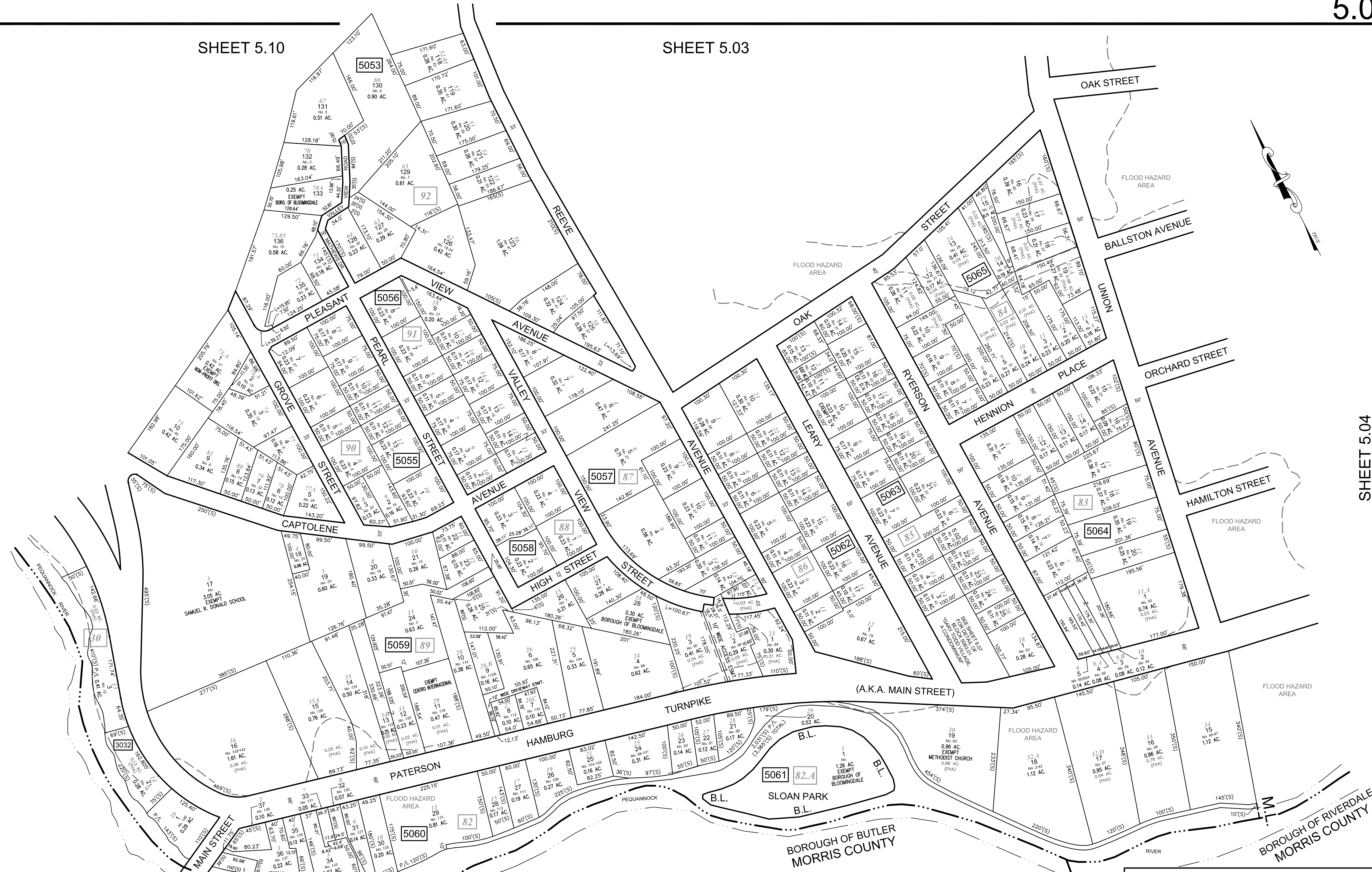
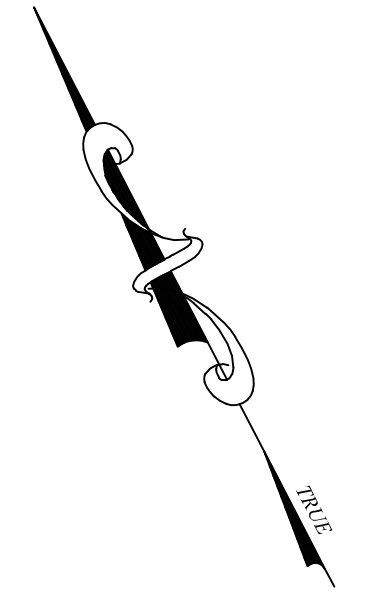

THIS MAP HAS BEEN DRAWN USING COMPUTER AIDED DRAFTING/DESIGN (CAD/D) UNDER THE SUPERVISION OF ROBERT L. CIGOL, N.J.L.S. No. 24GS04026100.

REVISIONS			
DATE	L. S. NAME	LIC. NO.	DESCRIPTION
11/14/16	R. CIGOL	24GS04026100	EXEMPT STATUS BL. 5053 L. 133 & SUBDIVISION OF BL. 5063 L. 5
11/15/17	R. CIGOL	24GS04026100	CORRECT STREET NAME (PLEASANT VIEW AVENUE)

NEW JERSEY DEPARTMENT OF THE TREASURY
 DIVISION OF TAXATION
 APPROVED AS A TAX MAP PURSUANT TO THE AUTHORITY OF
 N.J.S.A. 54:1-15 AND N.J.S.A. 54:50-1
 FOR THE DIRECTOR, DIVISION OF TAXATION

SIGNED BY: JUDY P. MILLER, C.T.A.
 SIGNED BY: TIFFANY A. FIELDS
 DATE: DEC 30, 2014 SERIAL NO. 1051

TAX MAP
BOROUGH OF BLOOMINGDALE
 PASSAIC COUNTY, NEW JERSEY
 SCALE: 1"=100' 01/01/2014

ROBERT L. CIGOL
 NEW JERSEY LICENSED LAND SURVEYOR
 LICENSE NO. 24GS04026100 CERTIFICATE OF AUTHORIZATION NO. 24GA27919000

DMC ASSOCIATES, INC.
 211 MAIN STREET
 BUTLER, N.J. 07405
 TO SHOW CONDITIONS AS OF 11/15/2017