

SHEET 5.10

SHEET 5.03

SHEET 3.05

SHEET 5.04

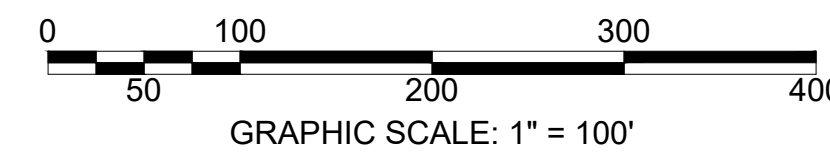
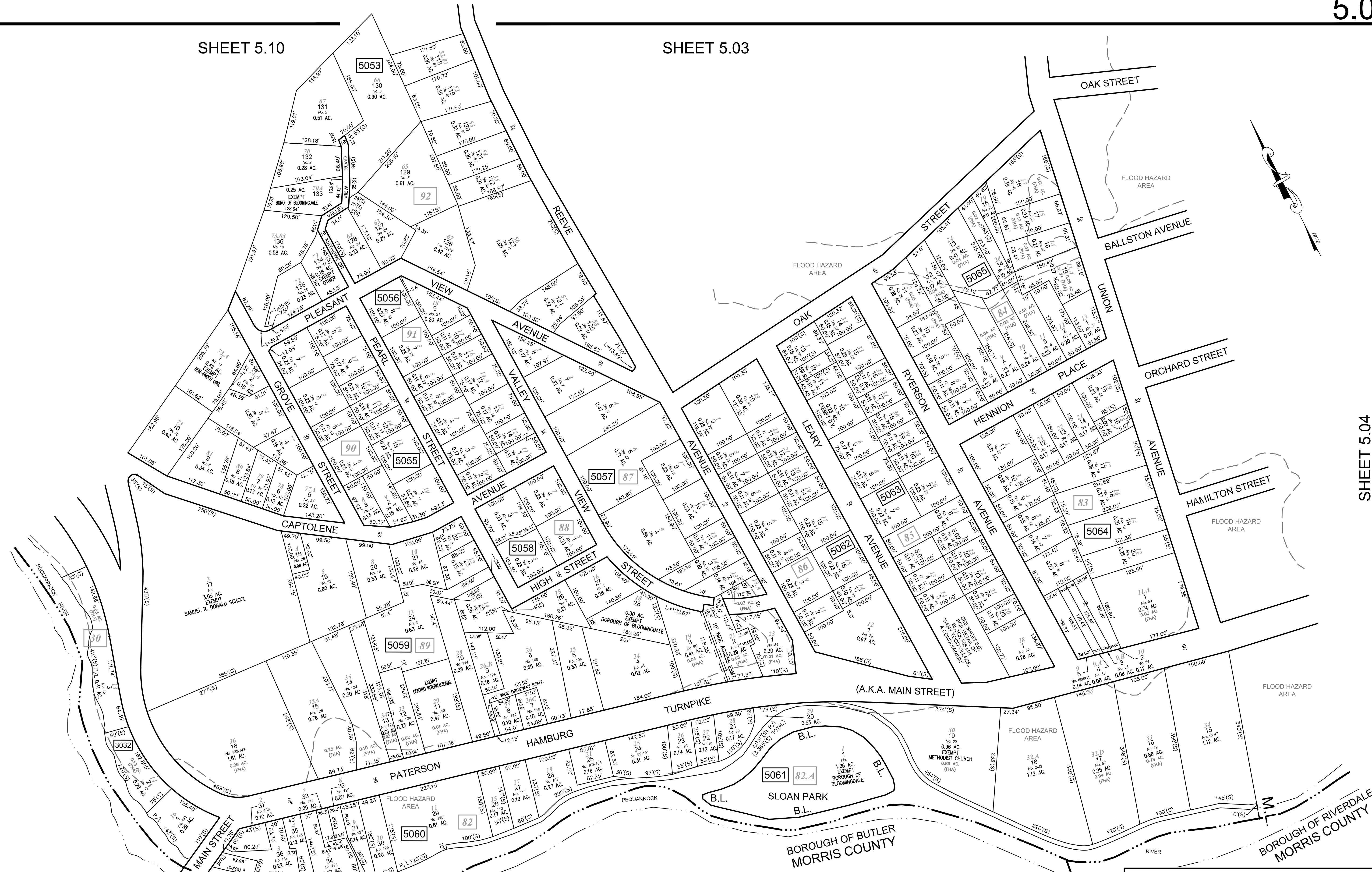
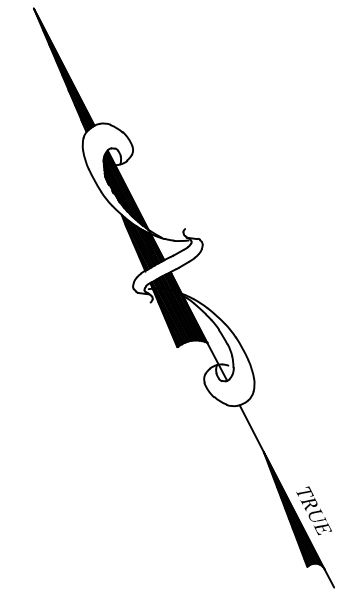

THIS MAP HAS BEEN DRAWN USING COMPUTER AIDED DRAFTING/DESIGN (CAD/D) UNDER THE SUPERVISION OF ROBERT L. CIGOL, N.J.L.S. No. 24GS04026100.

REVISIONS			
DATE	L. S. NAME	LIC. NO.	DESCRIPTION
11/14/16	R. CIGOL	24GS04026100	EXEMPT STATUS BL. 5053 L. 133 & SUBDIVISION OF BL. 5063 L. 5
11/15/17	R. CIGOL	24GS04026100	CORRECT STREET NAME (PLEASANT VIEW AVENUE)
10/25/19	R. CIGOL	24GS04026100	EXEMPT STATUS B. 5053 L. 134

NEW JERSEY DEPARTMENT OF THE TREASURY  
 DIVISION OF TAXATION  
 APPROVED AS A TAX MAP PURSUANT TO THE AUTHORITY OF  
 N.J.S.A. 54:1-15 AND N.J.S.A. 54:50-1  
 FOR THE DIRECTOR, DIVISION OF TAXATION

SIGNED BY: JUDY P. MILLER, C.T.A.  
 SIGNED BY: TIFFANY A. FIELDS  
 DATE: DEC 30, 2014 SERIAL NO. 1051

**TAX MAP**  
**BOROUGH OF BLOOMINGDALE**  
 PASSAIC COUNTY, NEW JERSEY  
 SCALE: 1"=100' 01/01/2014

**ROBERT L. CIGOL**  
 NEW JERSEY LICENSED LAND SURVEYOR  
 LICENSE NO. 24GS04026100 CERTIFICATE OF AUTHORIZATION NO. 24GA27919000

**DMC ASSOCIATES, INC.**  
 211 MAIN STREET  
 BUTLER, N.J. 07405  
 TO SHOW CONDITIONS AS OF 10/25/2019